

AERIAL REDDI™ Closure

Weight: 0.00kg

Dimensions: 0.00cm x 0.00cm x 0.00cm

Description

The **Aerial REDDI Closure** is designed specifically for free-breathing aerial use. A durable one-piece plastic shell with closing clamps is easily applied and re-entered.

Features

- Designed specifically for free-breathing aerial use
- Proven LOCK-TAPE Sealant System provides strong cable pull-out protection
- End Plate insert design grounds through the End Plates and facilitates aerial applications
- Easily applied and re-entered

Documentation

Application Procedures

[SP-2642 \(Aerial REDDI Closure\)](#)

Catalog Pages

[Aerial REDDI Closure - Catalog](#)

Part Tables

Catalog No.* (With Bonding)	Catalog No. (Without Bonding)	Closure Size (mm)	Carton Quantity
8006170	8006171	4.0" x 25.8" (102 x 655)	1
8006172	8006173	6.5" x 28.4" (76 x 655)	1
8006174	8006175	9.5" x 28.4" (241 x 721)	1
8006183	8006182	6.5" x 38.5" (165 x 978)	1
8006181	8006180	9.5" x 38.5" (241 x 978)	1

*Kit includes SURE-GRIP Shield Connectors and Bonding Braid

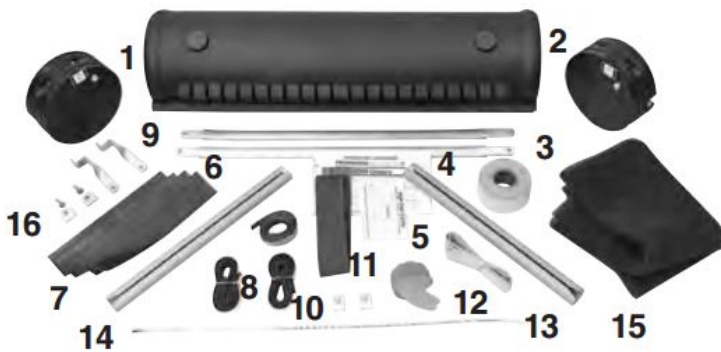

(Shown is an Aerial REDDI™ Closure Kit with bonding.)

- | | |
|------------------------------------|---------------------------------------|
| 1. Standard Two-Section End Plates | 9. Hanger (2) |
| 2. Shell | 10. SURE-GRIP™ Shield Connectors (2) |
| 3. Torque bars | 11. Emery cloth (for scuffing sheath) |
| 4. Application procedure | 12. Pair Protectors |
| 5. Cue Card | 13. Cable bonding braid |
| 6. Closing clamps | 14. CABLE Mea-SURE™ Tape |
| 7. LOCK-TAPE™ Sealant strips | 15. Spacer Mat |
| 8. End seals | 16. Bonding clamps |